

Travelling Merchant: _____

DATASHEET

Standard: **DP7L50M00001**

Plot			The Label
Drew	Audited	Approved	Stamp, please! Thanks!
Date: 2023.07.31			

Guangdong Dapu Telecom Technology Co.,LTD

Building 5, No.24, Industrial East Road, Songshanhu Park, Dongguan, Guangdong, P.R. China

TEL: 0086-0769-88010888 FAX: 0086-0769-81800098



1、 Electrical Parameters

	Parameters	SYM.	Electrical Spec.				Notes
			Min.	Typical	Max.	Unit	
1	Mercury Part No.		-				50MQ15A
2	Center Frequency	FL	50.000000			MHz	
3	Holder Type		-				5 * 7 * 1.3 6pads SMD Type
4	Crystal Cut		-				AT-Cut
5	Mode of Oscillation		-				Fundamental Mode
6	Pass Band Width		± 7.5	~		kHz	(at 3 dB)
7	Stop Band Width			~	± 25	kHz	(at 18 dB)
8	Ripple				1.0	dB	
9	Insertion Loss				2.0	dB	
10	Terminating Impdance		560 // 5.0			Ω // pF	
11	Operating Temperature		-20	~	70	°C	
12	Storage Temperature		-40	~	85	°C	
13	Lead Free Approved Report	SGS Taiwan Ltd. Report No. : ETR23404085					

Package Dimension (Unit : mm)

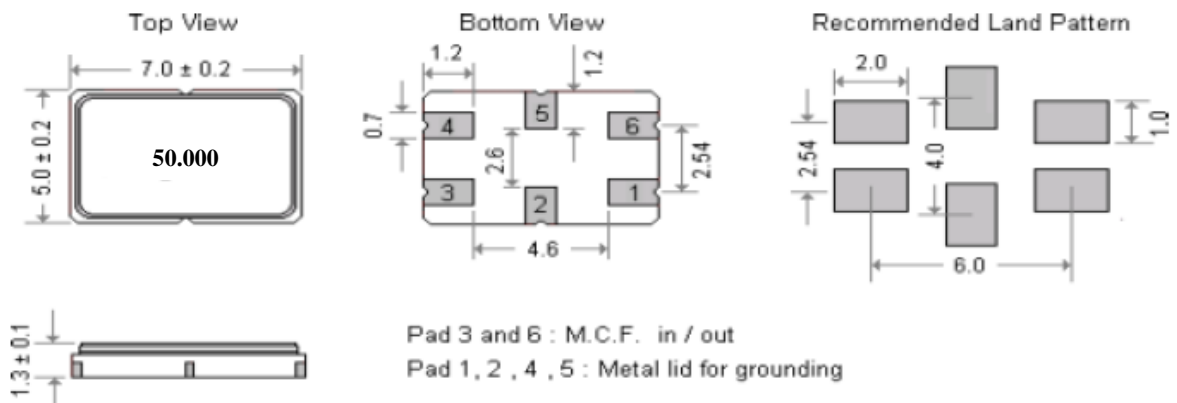



2、 Reflow Soldering Curve (RoHS)

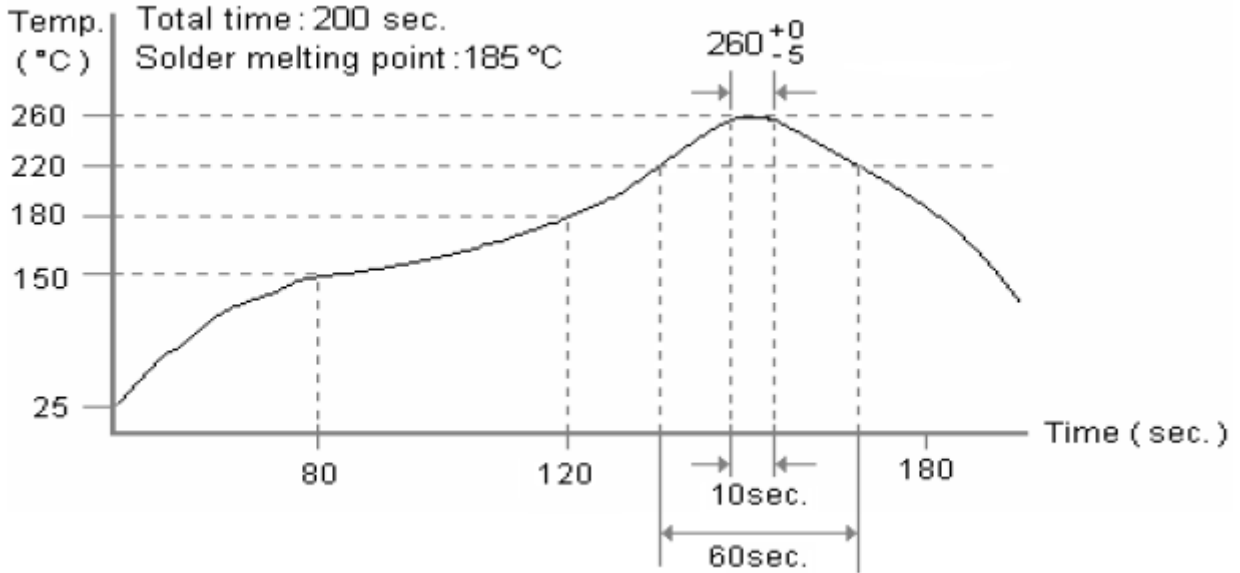

3、 Packing(mm)

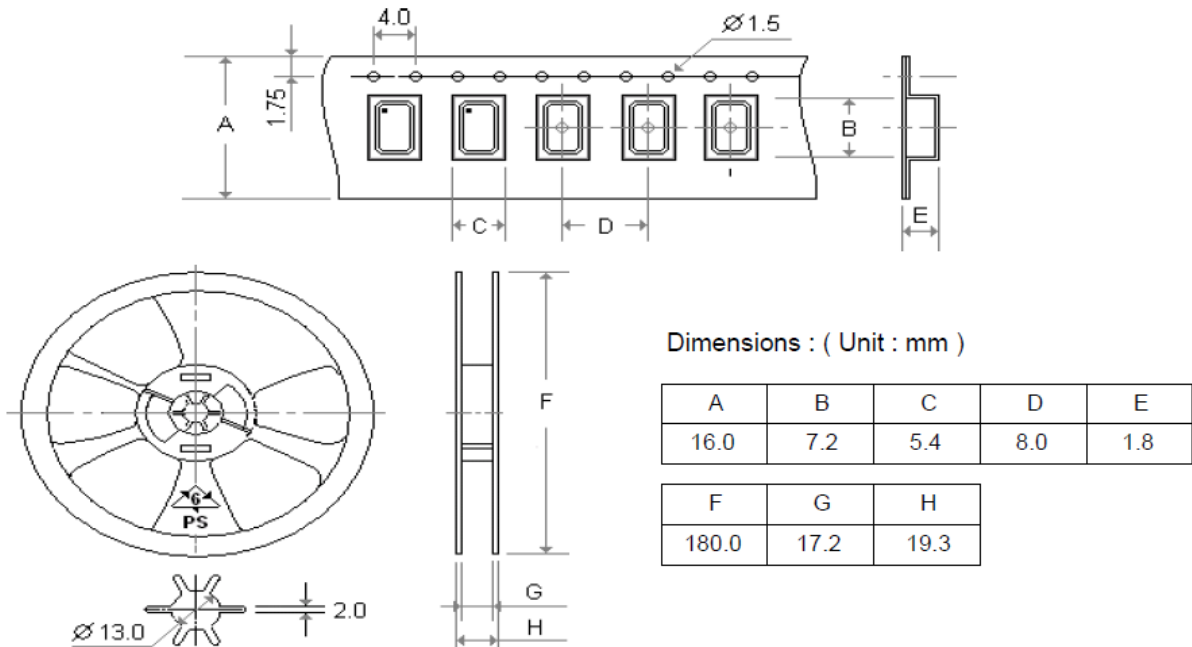

Remark :1. Standard reel quantity is 1000 pcs per reel .

2. 10 sprocket hold pitch cumulative tolerance is ±0.1 mm .

3. E measured from a place on the inside bottom of the pocket to the top surface of the carrier .