

Travelling Merchant: _____

DATASHEET

Standard: DP5X32768006

| Plot | | | The Label |
|------------------|---------|----------|------------------------|
| Drew | Audited | Approved | Stamp, please! Thanks! |
| | | | |
| Date: 2020.08.30 | | | |

Guangdong Dapu Telecom Technology Co.,LTD

Building 5, No.24, Industrial East Road, Songshanhu Park, Dongguan, Guangdong, P.R. China

TEL: 0086-0769-88010888 FAX: 0086-0769-81800098



1. Electrical Parameters

| MODEL: DP5X32768006 | | | | | | | |
|---------------------|---------------------------|------|------------------|------|-------|---------------------------|--|
| No. | Parameters | SYM. | Electrical Spec. | | | | Notes |
| | | | Min. | Typ. | Max. | Units | |
| 1 | Nominal Frequency | FL | 32.768 | | | KHz | |
| 2 | Oscillation Mode | - | Fundamental | | | - | |
| 3 | Load Capacitance | CL | 7 | | | pF | |
| 4 | Frequency Tolerance | - | -20 | | +20 | $\times 10^{-6}$ | $T_A=25^{\circ}\text{C} \pm 3^{\circ}\text{C}$ |
| 5 | Parabolic Coefficient | - | | | -0.04 | ppm/ $^{\circ}\text{C}^2$ | |
| 6 | Operating Temperature | - | -40 | | +85 | $^{\circ}\text{C}$ | |
| 7 | Storage Temperature Range | - | -55 | | +125 | $^{\circ}\text{C}$ | |
| 8 | Aging Per Year | - | -3 | | +3 | $\times 10^{-6}$ | |
| 9 | Drive Level | DL | | 0.1 | 0.5 | μW | |
| 10 | Motional capacitance | C1 | | 4.65 | | fF | |
| 11 | Shunt Capacitance | C0 | | 1.15 | | pF | |
| 12 | Insulation Resistance | - | 500 | - | - | M Ω | At DC 100V |
| 13 | Quality Factor | Q | 13 | | | K | |



2. Mechanical Structure(mm)

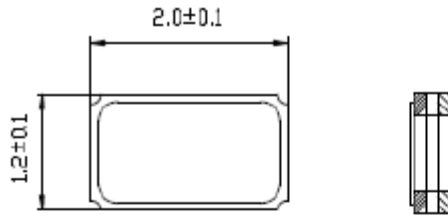

<TOP VIEW>

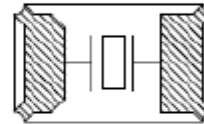
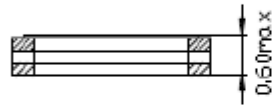

LAND PATTERN(REFERENCE)

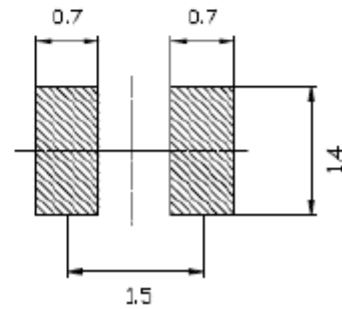
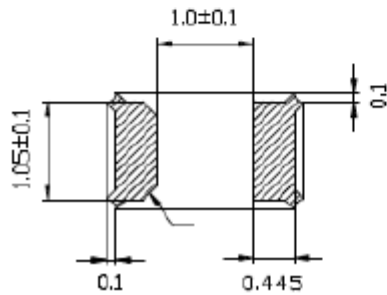



3. Package: Tape & Reel (mm)

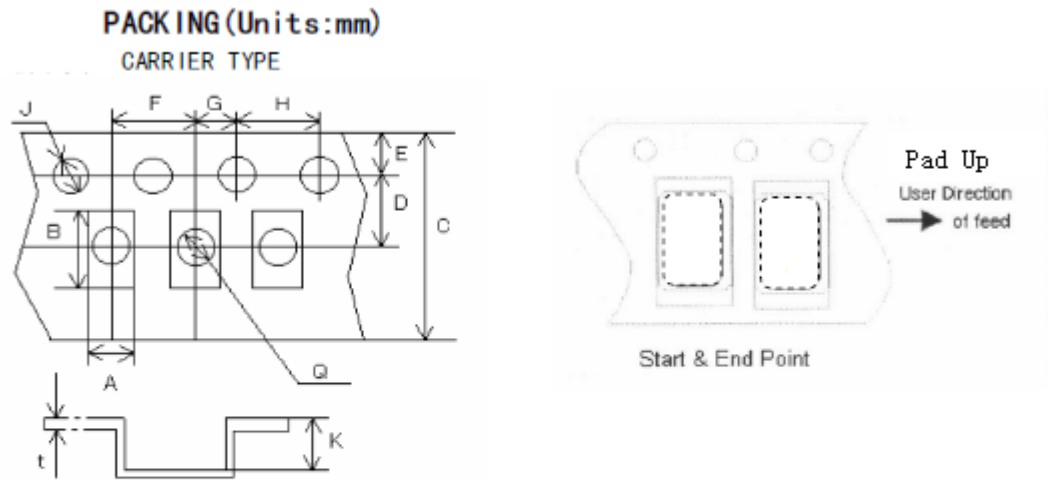

| A | B | C | D | E | F | G | H | J | K | t |
|-----|-----|-----|-----|------|-----|-----|-----|-----|------|------|
| 1.4 | 2.3 | 8.0 | 3.5 | 1.75 | 4.0 | 2.0 | 4.0 | 1.5 | 0.75 | 0.25 |

REMARK:

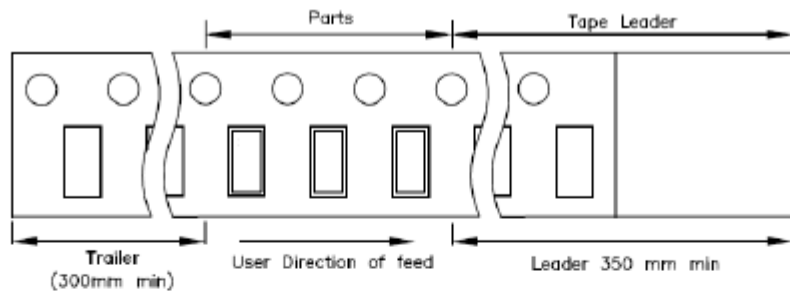

REEL: 3000 PCS/Reel

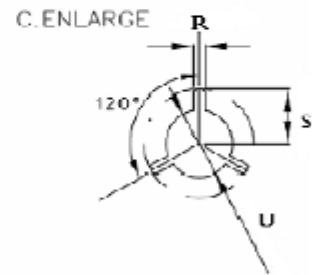
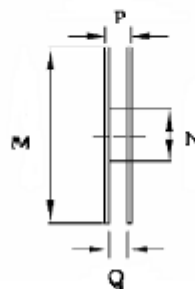
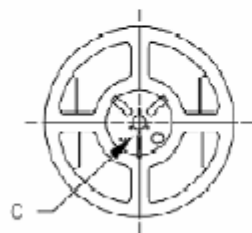

| M | N | P | Q | R | S | U |
|-----|------|------|-----|-----|------|------|
| 178 | 60.2 | 11.5 | 8.0 | 2.5 | 11.0 | 13.0 |