

Travelling Merchant: \_\_\_\_\_

# DATASHEET

Standard: DP5X32768002

Plot			The Label
Drew	Audited	Approved	Stamp, please! Thanks!
<i>Amway.wei</i>	<i>Carry.Wang</i>	<i>James.Liu</i>	
Date: 2019.11.13			

## Guangdong Dapu Telecom Technology Co.,LTD

Bldg13-16,.N.Ind.Zone,SSL Industry Park, Dongguan City, Guangdong Province, China

TEL: 0086-0769-88010888 FAX: 0086-0769-81800098



## 1、 Electrical Parameters

MODEL: DP5X32768001							
No.	Parameters	SYM.	Electrical Spec.				Notes
			Min.	Typ.	Max.	Units	
1	Nominal Frequency	FL	32.768			KHz	
2	Oscillation Mode	-	Fundamental			-	
3	Load Capacitance	CL	12.5			pF	
4	Frequency Tolerance	-	-20		+20	$\times 10^{-6}$	at 25°C $\pm$ 3°C
5	Parabolic Coefficient	-			-0.04	PPM/°C <sup>2</sup>	
6	Operating Temperature	-	-40		+85	°C	
7	Storage Temperature Range	-	-55		+125	°C	
8	Aging	-	-3		+3	$\times 10^{-6}$	+25°C, First year
9	Drive Level	DL		0.1	0.5	uW	
10	Equivalent Series Resistance				90	K $\Omega$	
11	Motional capacitance	C1	3.0	4.0	5.0	fF	
12	Shunt Capacitance	C0	0.7	1.0	1.3	pF	
13	Insulation Resistance	-	500	-	-	M $\Omega$	at DC 100V
14	Quality Factor	Q	13			K $\Omega$	
15	ESD Level	Human Body Model,class2: 2000V to 4000V; ANSI/ESDA/JEDEC JS-001-2010					
		Machine Model, class B: 200V to 400V; ANSI/ESDA/JEDEC JS-001-2010					
16	Moisture Sensitivity Level	Level 2					
17	Vibration	Test Condition: 0.75mm ;acceleration:10g;10Hz~2000Hz, one cycle per 30 min, test 2 hour. (3 times for each 3 directions X ,Y , Z). IEC 68-2-06 Test Fc.					
18	Shock	100g; 6ms; half sine wave (3 times for each 3 directions X ,Y , Z),IEC 68-2-27 Test Ea/Severity 50A.					



## 2、Equivalent Circuit

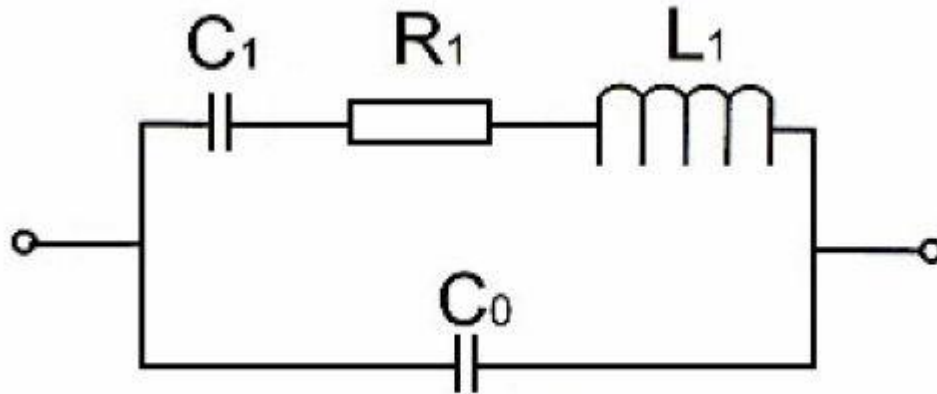

Equivalent Circuit

## 3、Mechanical Structure(mm)

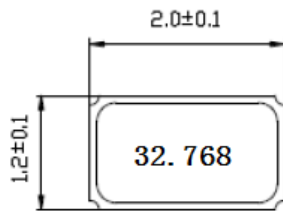

<TOP VIEW>

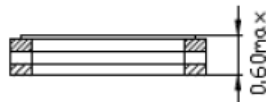

LAND PATTERN<REFERENCE>

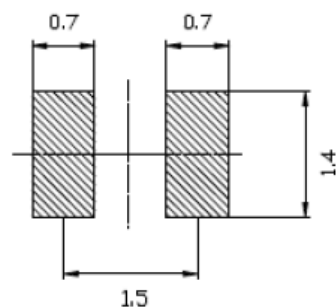
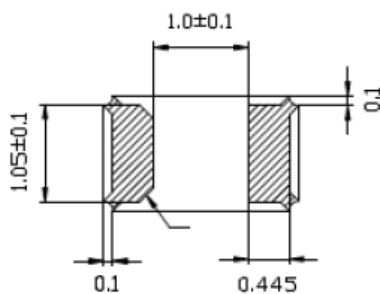



#### 4、 Package: Tape & Reel (mm)

CARRIER TYPE

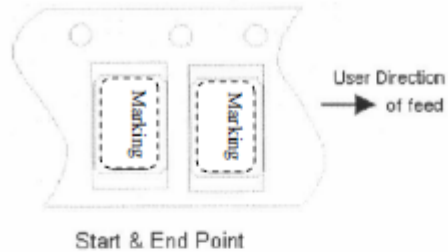
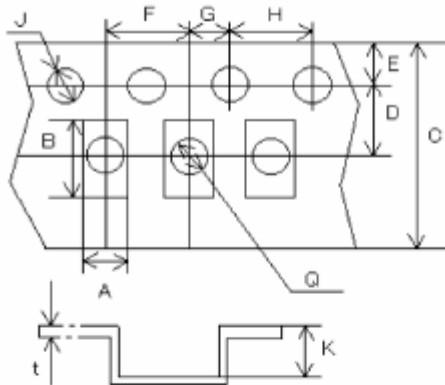

A	B	C	D	E	F	G	H	J	K	t
1.4	2.3	8.0	3.5	1.75	4.0	2.0	4.0	1.5	0.75	0.25

REMARK:

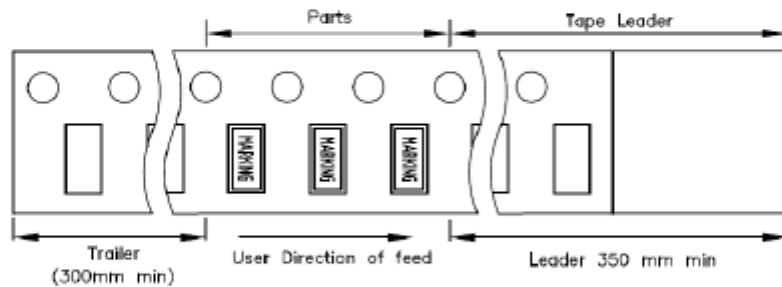

REEL: 3000 PCS/Reel

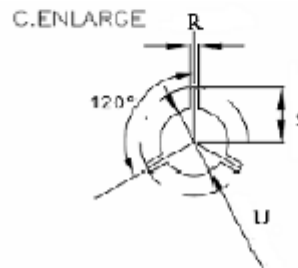
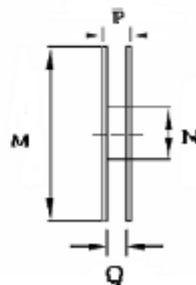
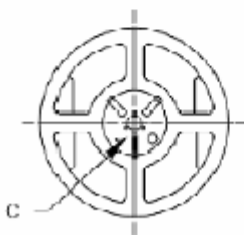

M	N	P	Q	R	S	U
178	60.2	11.5	8.0	2.5	11.0	13.0