

Travelling Merchant: \_\_\_\_\_

# DATASHEET

Standard: DP5X19200001

Plot			The Label
Drew	Audited	Approved	Stamp, please! Thanks!
Date: 2018.04.17			

## Guangdong Dapu Telecom Technology Co.,Ltd

Bldg13-16,.N.Ind.Zone,SSL Industry Park, Dongguan City, Guangdong Province, China

TEL: 0086-0769-88010888 FAX: 0086-0769-81800098



## 1、 Electrical Parameters

MODEL: DP5X19200001							
No.	Parameters	SYM.	Electrical Spec.				Notes
			Min.	Typ.	Max.	Units	
1	Nominal Frequency	FL	19.20			MHz	
2	Output Waveform	-	Clipped Sine wave				
3	Supply Voltage	V <sub>cc</sub>	2.52	2.8	3.08	V	
4	Current Drain	-			1.5	mA	
5	Output Level		0.8			V <sub>p-p</sub>	
6	Standard Output Load	-	1KΩ//5pF			-	
7	Frequency Tolerance	-	-1.0	-	1.0	× 10 <sup>-6</sup>	@25±2°C, 2hours or more at room ambient after 2 times reflow, based on nominal frequency
8	Frequency Stability vs. temperature	-	-0.5	-	0.5	× 10 <sup>-6</sup>	T <sub>A</sub> varied from -40°C to 85°C, measurement referenced to frequency observed with T <sub>A</sub> = 25°C, V <sub>cc</sub> =2.8V, O <sub>load</sub> =1KΩ//5pF
9	Frequency Stability vs. load		-0.2		+0.2	× 10 <sup>-6</sup>	10% load change measurement referenced to frequency observed with T <sub>A</sub> =25 °C, V <sub>cc</sub> =2.8V, O <sub>Load</sub> =1KΩ//5pF.
10	Frequency Tolerance vs. Supply Voltage		-0.2		+0.2	× 10 <sup>-6</sup>	V <sub>cc</sub> varied from 2.52V to 3.08V
11	Operating Temperature Range	-	-40	~	+85	°C	
12	Storage Temperature	-	-40	-	+85	°C	
13	Start Up Time				2.0	ms	To 90% of outout amplitude
14	Aging	-	-1.0	-	+1.0	× 10 <sup>-6</sup>	Over 1st Year
15	Frequency Tuning Range		-12		-18	× 10 <sup>-6</sup>	V <sub>c</sub> =0.5V. measurement referenced to V <sub>c</sub> =1.5V
16			+18		+12	× 10 <sup>-6</sup>	V <sub>c</sub> =2.5V. measurement referenced to V <sub>c</sub> =1.5V
17	Linearity				10	%	
18	Slope		Positive				
19	Input Impedance		500			KΩ	



20	Phase Noise			-90		dBc/Hz	@10Hz Offset
				-115			@100Hz Offset
				-135			@1KHz Offset
				-145			@10KHz Offset
				-148			@100KHz Offset
				-150			@1MHz Offset
21	ESD Level	Human Body Model,class2: 2000V to 4000V; ANSI/ESDA/JEDEC JS-001-2010.					
22		Machine Model, class B: 200V to 400V; ANSI/ESDA/JEDEC JS-001-2010.					
23	Moisture Sensitivity Level	Level 2.					
24	Vibration	Test Condition: 0.75mm ;acceleration:10g;10Hz~2000Hz, one cycle per 30 min, test 2 hour. (3 times for each 3 directions X , Y , Z) .IEC 68-2-06 Test Fc.					
25	Shock	100g; 6ms; half sine wave (3 times for each 3 directions X , Y , Z ),IEC 68-2-27 Test Ea/Severity 50A.					



## 2、Mechanical Structure(mm)

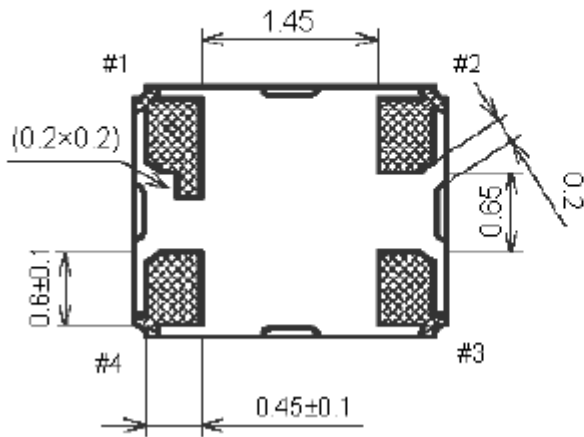
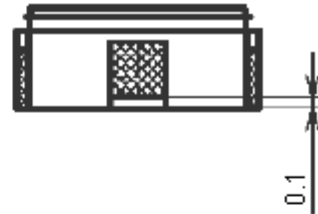
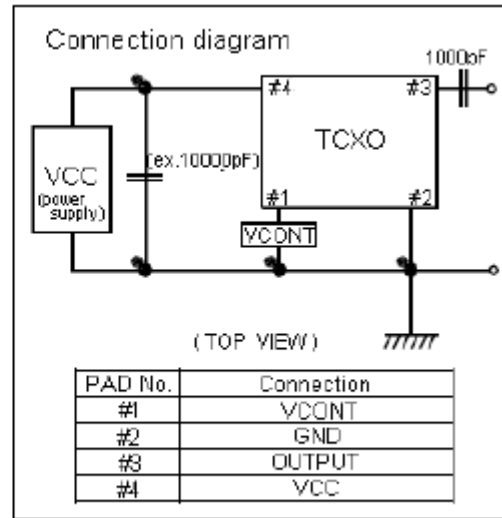
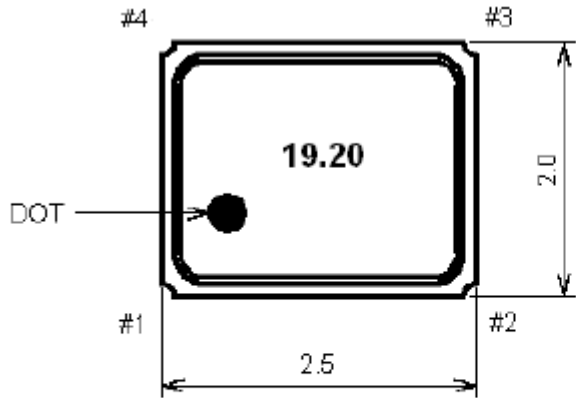

Note1: Tolerance ±0.2mm



### 3、Reflow Soldering Curve (RoHS)

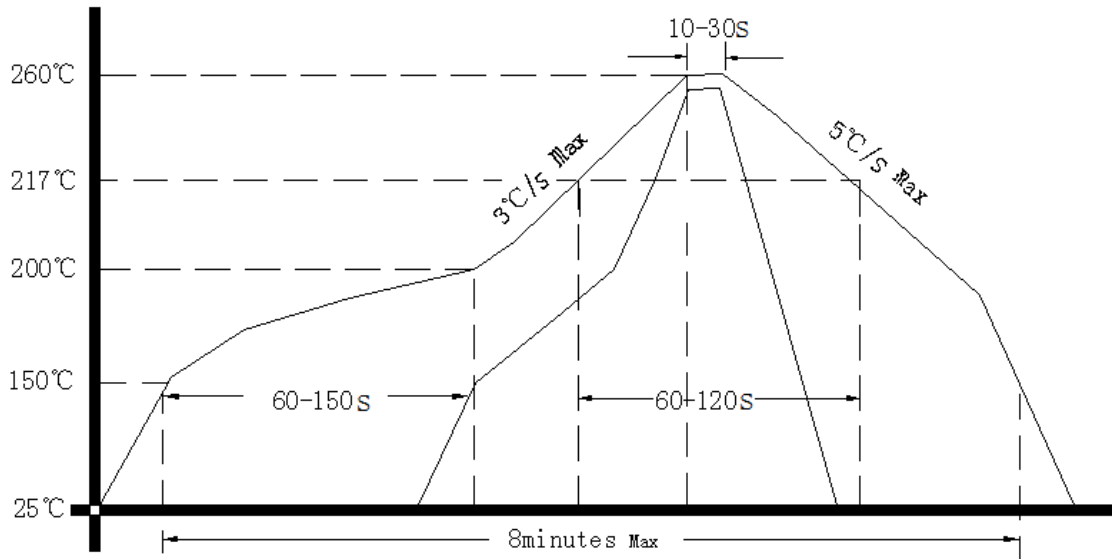

### 4、Package: Tape & Reel (mm)

