

Travelling Merchant: _____

DATASHEET

Standard: **DP7X10000004**

Plot			The Label
Drew	Audited	Approved	Stamp, please! Thanks!
Date: 2016.07.08			

Guangdong Dapu Telecom Technology Co.,Ltd

Bldg13-16,.N.Ind.Zone,SSL Industry Park, Dongguan City, Guangdong Province, China

TEL: 0086-0769-88010888 FAX: 0086-0769-81800098



1、 Electrical Parameters

MODEL: DP7X1000004								
No	Parameters	SYM.	Electrical Spec.				Notes	
			Min.	Typ.	Max.	Units		
1	Nominal Frequency	FL	10.00			MHz	One frequency-division	
2	Supply Voltage	VDD	1.7		3.5	V		
3	Current consumption	-	-	-	1.5	mA		
4	Output Level	-	0.8	-	-	Vp-p		
5	Output Waveform	-	Clipped Sine wave			-		
6	Standard Output Load	-	10KΩ//10pF			-		
7	Frequency Stability	vs. Tolerance	-1.5	-	+1.5	$\times 10^{-6}$	After 2 times reflow	
8		vs. Temperature	-	-0.5	-	+0.5	$\times 10^{-6}$	TA=-30~+85°C Ref. to Frequency (TA=+25° C)
			-	-1.0	-	+1.0	$\times 10^{-6}$	TA=-40~+85°C Ref. to Frequency (TA=+25° C)
9		vs. Load	-	-0.2	-	+0.2	$\times 10^{-6}$	Load:1KΩ//5Pf , ±10% each
10		vs. Supply Voltage	-	-0.2	-	+0.2	$\times 10^{-6}$	+3.3 V +/-5%.
11	Operating Temperature Range	-	-40	~	+85	°C		
12	Storage Temperature	-	-40	~	+85	°C		
13	Start Up Time	-	-	-	2.0	ms	@90% of final Vout level	
14	Duty Cycle	-	40	~	60	%		
15	Aging	-	-1.0	-	+1.0	$\times 10^{-6}$ /year	TA=Room ambient	
16	Linearity	-	-	-	10	%		
17	slope		Positive					
18	Input Impedance	-	500	-	-	KΩ		
19	Phase Noise	@ 10Hz Offset	-	-	-90	dBc/Hz		
20		@ 100Hz Offset	-	-	-115			
21		@ 1KHz Offset	-	-	-135			
22		@ 10KHz Offset	-	-	-145			
23		@ 100KHz Offset	-	-	-145			
24		@ 1MHz Offset	-	-	-150			



25	ESD Level	Human Body Model,class2: 2000V to 4000V; ANSI/ESDA/JEDEC JS-001-2010.
		Machine Model, class B: 200V to 400V; ANSI/ESDA/JEDEC JS-001-2010.
26	Moisture Sensitivity Level	Level 2.
27	Vibration	Test Condition: 0.75mm ;acceleration:10g;10Hz~2000Hz, one cycle per 30 min, test 2 hour. (3 times for each 3 directions X ,Y , Z) .IEC 68-2-06 Test Fc.
28	Shock	100g; 6ms; half sine wave (3 times for each 3 directions X ,Y, Z),IEC 68-2-27 Test Ea/Severity 50A.

2、Mechanical Structure(mm)

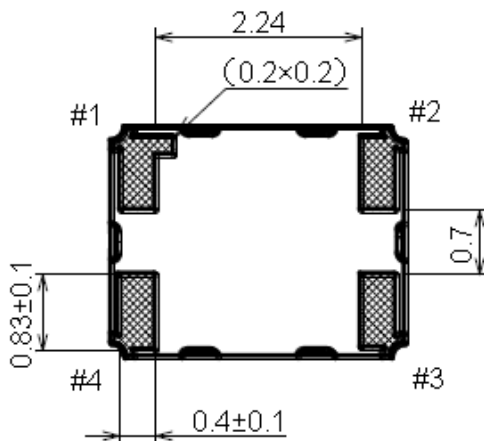
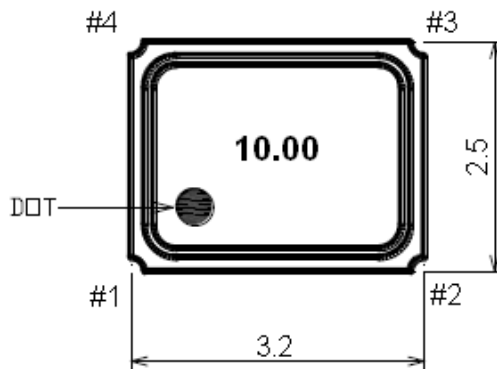

PAD No.	Connection
#1	VCONT
#2	GND
#3	OUTPUT
#4	VCC

Note1: Tolerance $\pm 0.2\text{mm}$



3、 Reflow Soldering Curve (RoHS)

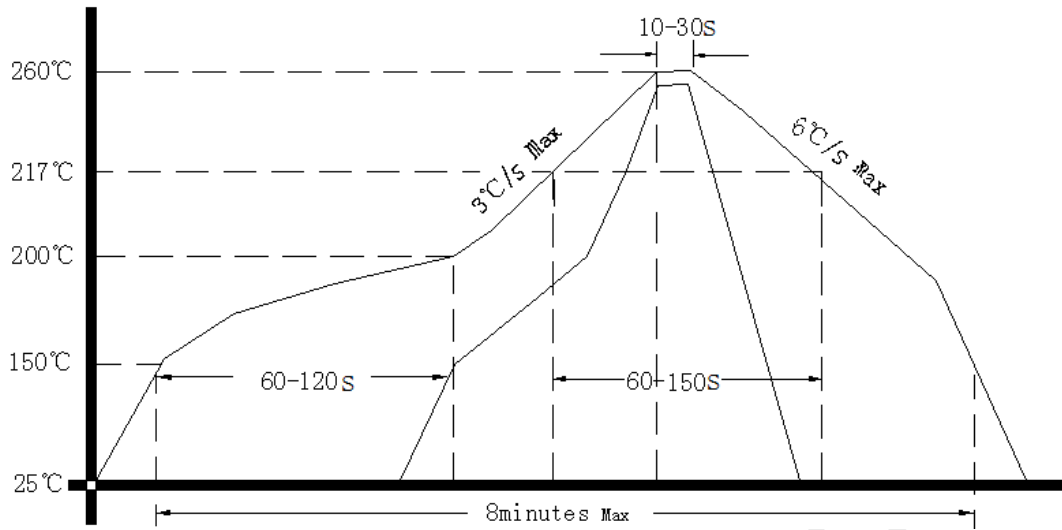

4、 Package: Tape & Reel (mm)

