

Customer Code : _____

DATASHEET

DAPU P/N: **DP6U60000001**

Plot			The Label
Drew	Audited	Approved	Stamp, please! Thanks!
Date: 2021.10.13			

Guangdong Dapu Telecom Technology Co.,Ltd

Building 5, No.24, Industrial East Road, Songshanhu Park, Dongguan, Guangdong, P.R. China

TEL: 0086-0769-88010888 FAX: 0086-0769-81800098



1、Electrical Parameters

MODEL: DP6U6000001							
No.	Parameters	SYM.	Electrical Spec.				Notes
			Min.	Typ.	Max.	Units	
1	Nominal Frequency	FL	60.00			MHz	
2	Output Waveform		CMOS				
3	Output Load				15	pF	
4	Duty Cycle	DC	45	50	55	%	
5	Supply Voltage		2.97	3.3	3.63	V	
6	Frequency Stability (Overall)		-50		+50	$\times 10^{-6}$	Frequency stability includes frequency tolerance@25°C and Stability@ Temperature. and voltage variance and first year aging.
7	Operating Temperature	T-opr	-40		+85	°C	
8	Storage Temperature	T-stg	-55	~	+125	°C	
9	Rise/Full Time	Tr、Tf			4	nS	10%-90% Output Swing
10	Aging		-3		+3	$\times 10^{-6}$	First year
12	Output Voltage High	VOH	2.97	-	-	V	
13	Output Voltage Low	VOL	-	-	0.33	V	
14	Tri-State Output Active		2.31 or Floating			V	Pin 2 Tri-state Enable High.
15	Tri-State Output in High-Impedance state				0.99	V	
16	Start-up Time		-	-	5	ms	
17	Pull Range		± 100			$\times 10^{-6}$	
18	Control Voltage Range	VC	0.3	1.65	3	V	
19	Absolute Pull Range	APR	± 50			$\times 10^{-6}$	
20	Linearity				10	%	
21	Modulation Bandwidth		15			KHz	
22	VC Input Impedance		2000			K Ω	
23	Phase Jitter (Pk-Pk)				200	ps	
24	Phase Noise				-90	dBc	100Hz
					-120		1KHz
					-135		10KHz
					-150		100KHz



2、Mechanical Structure(mm)

[TOP VIEW]

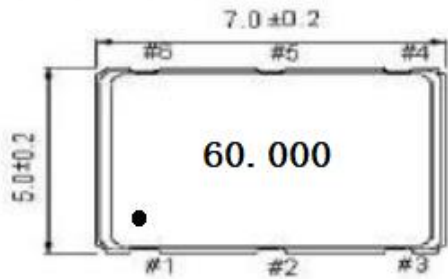

Pin 1 Mark

[SIDE VIEW]

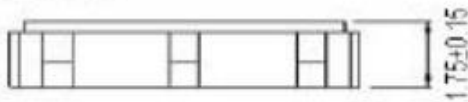

[BOTTOM VIEW]

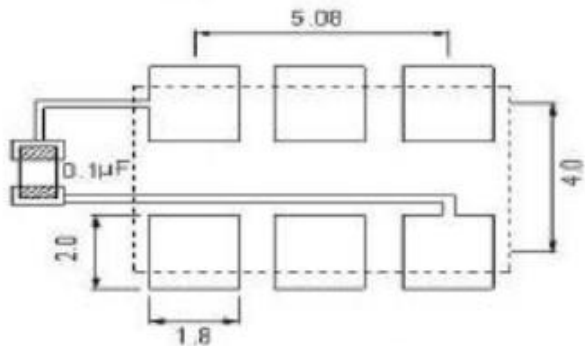
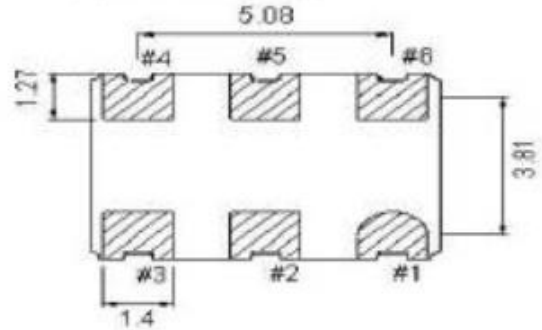

Recommended soldering pattern

Pin	Function
#1	Vcon
#2	Tri-State
#3	GND
#4	Output
#5	NC
#6	VDD

Note1: Tolerance ± 0.2 mm without mark