

Travelling Merchant: \_\_\_\_\_

# DATASHEET

Standard:                   **DPAF32768001**                  

| Plot             |         |          | The Label              |
|------------------|---------|----------|------------------------|
| Drew             | Audited | Approved | Stamp, please! Thanks! |
|                  |         |          |                        |
| Date: 2021.05.13 |         |          |                        |

## Guangdong Dapu Telecom Technology Co.,LTD

Building 5, No.24, Industrial Road East, Songshanhu Park, Dongguan, Guangdong, P.R. China

TEL: 0086-0769-88010888 FAX: 0086-0769-81800098



## 1、 Electrical Parameters

| MODEL: DPAF32768001 |                              |  |                  |      |       |                     |              |
|---------------------|------------------------------|--|------------------|------|-------|---------------------|--------------|
| No.                 | Parameters                   | SYM.   | Electrical Spec. |      |       |                     | Notes        |
|                     |                              |  | Min.             | Typ. | Max.  | Units               |              |
| 1                   | Nominal Frequency            | FL   | 32.768           |      |       | KHz                 |              |
| 2                   | Oscillation Mode             | -  | Fundamental      |      |       | -                   |              |
| 3                   | Load Capacitance             | CL   | 12.5             |      |       | pF                  |              |
| 4                   | Frequency Tolerance          | -  | -20              | ~    | +20   | $\times 10^{-6}$    | at 25°C± 3°C |
| 5                   | Parabolic Coefficient        | -  | -                | ~    | -0.04 | PPM/°C <sup>2</sup> |              |
| 6                   | Operating Temperature        | -  | -40              | ~    | +85   | °C                  |              |
| 7                   | Storage Temperature Range    | -  | -55              | ~    | +125  | °C                  |              |
| 8                   | Aging                        | -  | -3               | ~    | +3    | $\times 10^{-6}$    | Per year     |
| 9                   | Drive Level                  | DL   | -                | 0.1  | 0.5   | uW                  |              |
| 10                  | Equivalent Series Resistance | Rr   | -                | -    | 70    | KΩ                  |              |
| 11                  | Shunt Capacitance C0         | C0   | -                | 1.1  | -     | pF                  |              |
| 12                  | Motional Capacitance         | C1   | -                | 4.1  | -     | pF                  |              |
| 13                  | Insulation Resistance        | -  | 500              | -    | -     | MΩ                  | at DC 100V   |
| 14                  | ESD Level                    | Human Body Model,class2: 2000V to 4000V; ANSI/ESDA/JEDEC JS-001-2010   |                  |      |       |                     |              |
|                     |                              | Machine Model, class B: 200V to 400V; JEDEC JESD22-A115C.  |                  |      |       |                     |              |
| 15                  | Moisture Sensitivity Level   | Level 2  |                  |      |       |                     |              |
| 16                  | Vibration                    | Test Condition: 0.75mm ;acceleration:10g;10Hz~2000Hz, one cycle per 30 min, test 2 hour. (3 times for each 3 directions X , Y , Z). IEC 68-2-06 Test Fc. |                  |      |       |                     |              |
| 17                  | Shock                        | 100g; 6ms; half sine wave (3 times for each 3 directions X , Y , Z),IEC 68-2-27 Test Ea/Severity 50A.  |                  |      |       |                     |              |



## 2、Mechanical Structure(mm)

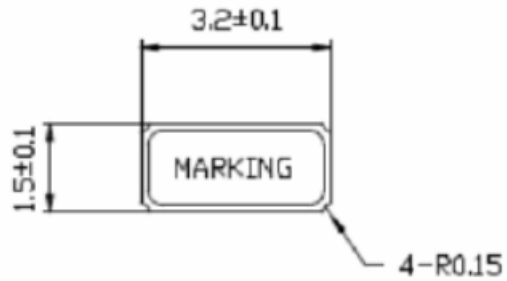

<TOP VIEW>

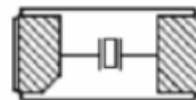
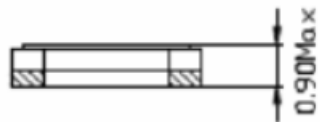

LAND PATTERN(REFERENCE)

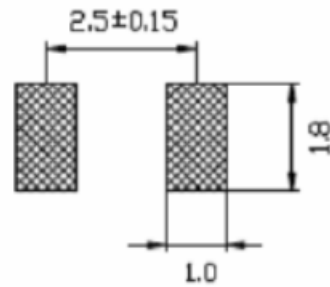
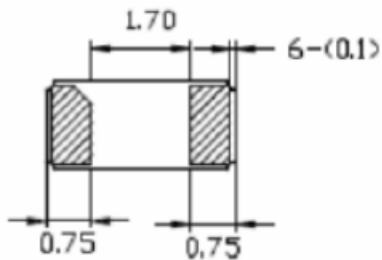



### 3、 Package: Tape & Reel (mm)

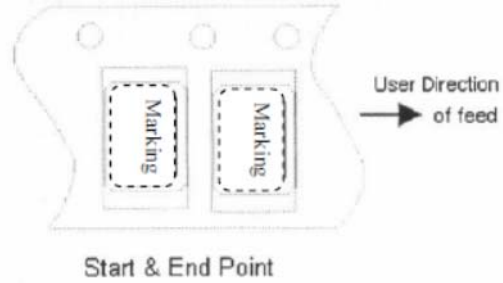
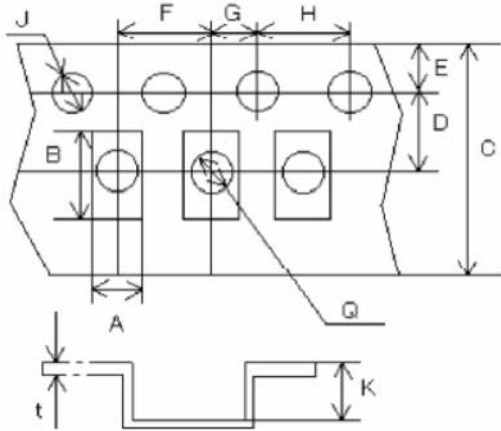

| A    | B    | C    | D   | E    | F   | G   | H   | J   | K   | t    |
|------|------|------|-----|------|-----|-----|-----|-----|-----|------|
| 1.75 | 3.45 | 12.0 | 5.5 | 1.75 | 4.0 | 2.0 | 4.0 | 1.5 | 1.0 | 0.25 |

REMARK :

