



DP0668S

ENG PART:DP-35x42ID-617T746-CCW

617MHz to 652MHz & 728MHz to 746MHz Single Junction Drop-in Isolator

REV.	DESCRIPTION	REVISOR	DATE	APPROVED
A	Creating datasheet	ZC.Wu	2021/9/18	Nick

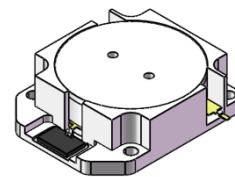

Applications:

- Wireless Infrastructure
- Power Amplifier

Features:

- Operating frequency range: 617MHz to 652MHz
728MHz to 746MHz
- Operating temperature range: -40°C to +90°C
- Storage temperature range: -40°C to +120°C
- Small surface-mount package delivered on T&R
- BeOfree&RoHS compliant

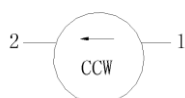

Block Diagram



Electrical Specifications:

ITEM	SPECIFICATION	
Frequency	617~652 & 728~746	MHz
Direction	CCW	
Impedance	Typ: 50	Ω
Insertion Loss (Max.)	0.20@-40℃~+90℃ 0.25@extended temp.	dB
Isolation (Min.)	28.0(desired) 25.0@-40℃~+90℃	dB
Return Loss (Min.)	Port 1: 28.0@25℃±5℃ 25.0@-40℃~+90℃ Port 2: 25.0@-40℃~+90℃	dB
Forward 3rd IMD order P1 (Max.)	-75@2x43 dBm CW tones	dBc
Reverse 3rd IMD order P2 (Max.) RBW=300KHz, VBW=300KHz	-89.5	dBc
Group delay	-	ns
2nd harmonic	-47	dBc
Power handing (Avg.) P1 (MIN.)	200	W
Power handing (Peak.) P1 (MIN.)	1000 (0.01% duty cycle)	W
Power handing (Avg.) P2 (MIN.)	150 (1minute)	W
Reverse Power (Avg.) P2 (Max.)	100(indefinite time ,100℃ base plate)	W
Termination/Attenuator	-	W/dB
Input Impedance ,real	-	Ω
Input Impedance ,imaginary		Ω
Output Impedance ,real	-	Ω
Output Impedance ,imaginary	-	Ω

Notes:

1. Exposure to maximum rating conditions for extended periods may reduce device reliability. There is no damage to device with only one parameter set at the limit and all other parameters set at or below their nominal value. Exceeding any of the limits listed here may result in permanent damage to the device.
2. Performance is guaranteed under the conditions listed in this table and over the operating temperature range.



Mechanical Specifications:

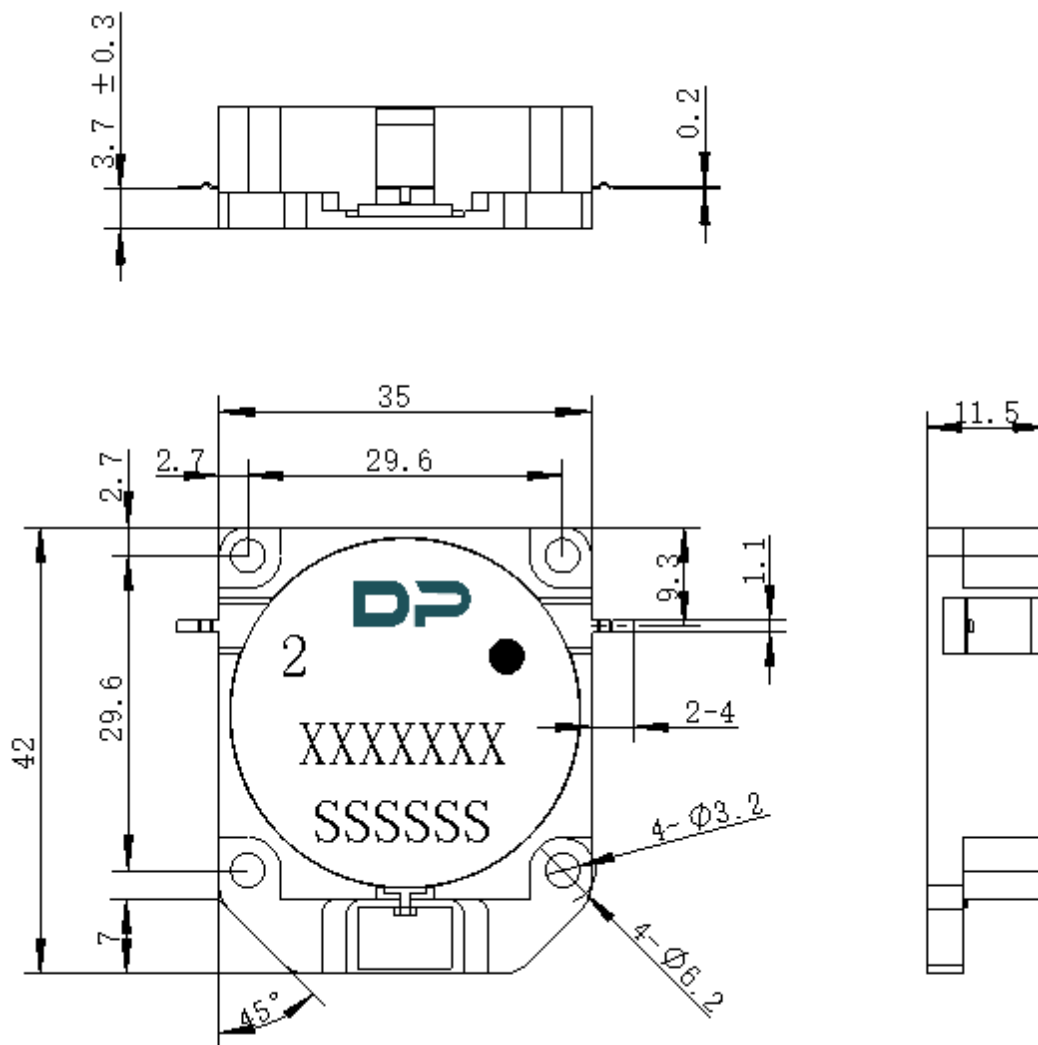

Unit: Millimeters

Notes:

1. The housing is nickel-plated and the tab is silver-plated.
2. Tolerance ± 0.2 mm unless otherwise specified.
3. Co-planarity Specification: 0.1 mm maximum.
4. Part Number, Lot Code, and Port Designation are printed on the top side of device.
5. The XXXXXXX on the label represents the part number
6. The SSSSSS on the label represents the serial number
7. The black dot on the label represents the input port



GuangdongDapuTelecomTechnologyCo.,Ltd

<http://www.dptel.com>

Bldg13-16,.N.Ind.Zone,SSLIndustry
Park,DongguanCity,Guangdong
Province,PRChina
TEL:0086-0769-88010888
FAX:0086-0769-81800098
